

**LOS ANGELES COUNTY
DEPARTMENT OF PUBLIC WORKS**

BENCHMARKS



POMONA QUAD

**2005 ADJUSTMENT
2005 BASELINE
NAVD 88 DATUM FOOT/METER**

PREFACE

The Department of Public Works level net is composed of more than 1,700 miles or 2720 kilometers of levels supporting in excess of 9,000 benchmarks. Previously when a major readjustment of the net was undertaken, to emphasize the complete break with previous elevations, the CY, CG, and CL, series benchmarks were re-labeled DY, DG, and DL, respectively. Beginning in 1993 the Baseline readjustment year will be indicated on Baseline BM's, as indicated below (*). Henceforth all BM numbers will be labeled as a Y, G, or L series that will no longer indicate the major adjustment year.

To facilitate the adjustment, indexing and distribution of the adjusted values of the net, the county territory was divided into 33 quads or areas. For the identification purposes each quad was given a name (i.e. "Rosemead", "La Mirada", and "Santa Fe"...etc). When benchmarks and elevations in the quad are used, the name of the bench and quad must be stated in the description, i.e.:

(*)	BASELINE	90.057	L&BR IN CTR OF CB RET @ NE COR	Y 9191
	(1990)	295.461	LA HABRA BLVD & VALLEY HOME AVE	

It is expected that this general adjustment will for the most part remain sound for 8 to 10 years. Updating constrained adjustments will continue in the future. When a quad is readjusted, new elevations will be published and the date of readjustment will be noted in the benchmark description. Two benchmarks with different adjustment dates will not normally agree with each other.

The basic accuracy of the net is reflected by an indicated field probable error of ± 0.017 feet per mile (4mm per kilometer) of leveling as determined from conditions of closure. However, many years of experience in vertical control in the greater Los Angeles basin and Antelope Valley indicates that because of varying degrees of subsidence and heaving, the true datum is recovered only by obtaining substantial agreement of a number of benchmarks.

The users of this network of benchmarks are invited to assist in its maintenance by notifying this department of cases of obliteration, apparent mistakes in descriptions or elevations, and the disturbance of benchmarks.

Datum: North American Vertical Datum of 1988 (NAVD88)

Note: NAVD 1988 minus approximately 2.3 feet (70 cm) equals NGVD 1929 Datum. For more accurate equations at individual benchmarks refer to previous publications.

Abbreviations used in Benchmark Descriptions

Abbreviations	Descriptions	Abbreviations	Descriptions
<i>ABUT</i>	Abutment	<i>LT</i>	Lead and Tack
<i>ALG</i>	Along	<i>LACE</i>	Los Angeles City Engineer
<i>ANG PT</i>	Angle Point	<i>LACS</i>	La County Engineer
<i>B/W</i>	Back of Walk	<i>LAFC</i>	La County Flood Control
<i>BCR</i>	Begin Curb Return	<i>L&BN</i>	Lead and Bench Nail
<i>BC</i>	Begin Curve	<i>L&BR</i>	Lead and Brad
<i>BLDG</i>	Building	<i>L&N</i>	Lead and Nail
<i>BM</i>	Benchmark	<i>L&SPK</i>	Lead and Spike
<i>BT SPK</i>	Boat or Bolt Spike	<i>L&T</i>	Lead and Tack
<i>BR CAP</i>	Brass Cap Monument	<i>MCR</i>	Middle Curb Return
<i>C B</i>	Catch Basin	<i>MKD</i>	Marked
<i>CTR</i>	Center	<i>MC</i>	Middle Curve
<i>C/L</i>	Centerline	<i>MON</i>	Monument
<i>C/L INT</i>	Centerline Intersection	<i>N/O</i>	North of
<i>C/L PROD</i>	Centerline Produced	<i>NR</i>	Near
<i>CONC</i>	Concrete	<i>OPP</i>	Opposite
<i>COR</i>	Corner	<i>PI</i>	Point of Intersection
<i>COE</i>	Corps of Engineers	<i>PK&W</i>	PK Nail and Washer
<i>CULV</i>	Culvert	<i>P/L</i>	Property Line
<i>CYN</i>	Canyon	<i>POST</i>	Point on Simi-Tangent
<i>CB</i>	Curb	<i>PP</i>	Power Pole
<i>CS MON</i>	Co. Eng. Monument	<i>PVMT</i>	Pavement
<i>CT SPK</i>	Cut Spike	<i>PROD</i>	Produced
<i>DPW</i>	Dept of Public Works	<i>RD</i>	Road
<i>DR</i>	Driveway	<i>RDBM</i>	Road Dept Benchmark
<i>E/O</i>	East of	<i>RDBM TAG</i>	Road Dept Benchmark Tag
<i>ECR</i>	End Curb Return	<i>RR</i>	Railroad
<i>EC</i>	End Curve	<i>R/W</i>	Right of Way
<i>ENT</i>	Entrance	<i>SDMH</i>	Storm Drain Manhole
<i>FL</i>	Flow line	<i>SMH</i>	Sewer Manhole
<i>FTG</i>	Footing	<i>SPK</i>	Spike
<i>FRWY</i>	Freeway	<i>ST&W</i>	Spike Tin and Washer
<i>F/W</i>	Front of Walk	<i>S/O</i>	South of
<i>GAR</i>	Garage	<i>TP</i>	Telephone Pole
<i>HDWL</i>	Head Wall	<i>USC&GS</i>	US Coast and Geodetic Survey
<i>HSE</i>	House	<i>USGS</i>	US Geological Survey
<i>HWY</i>	Highway	<i>WK</i>	Walk
<i>INT</i>	Intersection	<i>W/O</i>	West of
<i>IP</i>	Iron Pipe		

QUAD COVERAGE INDEX MAP

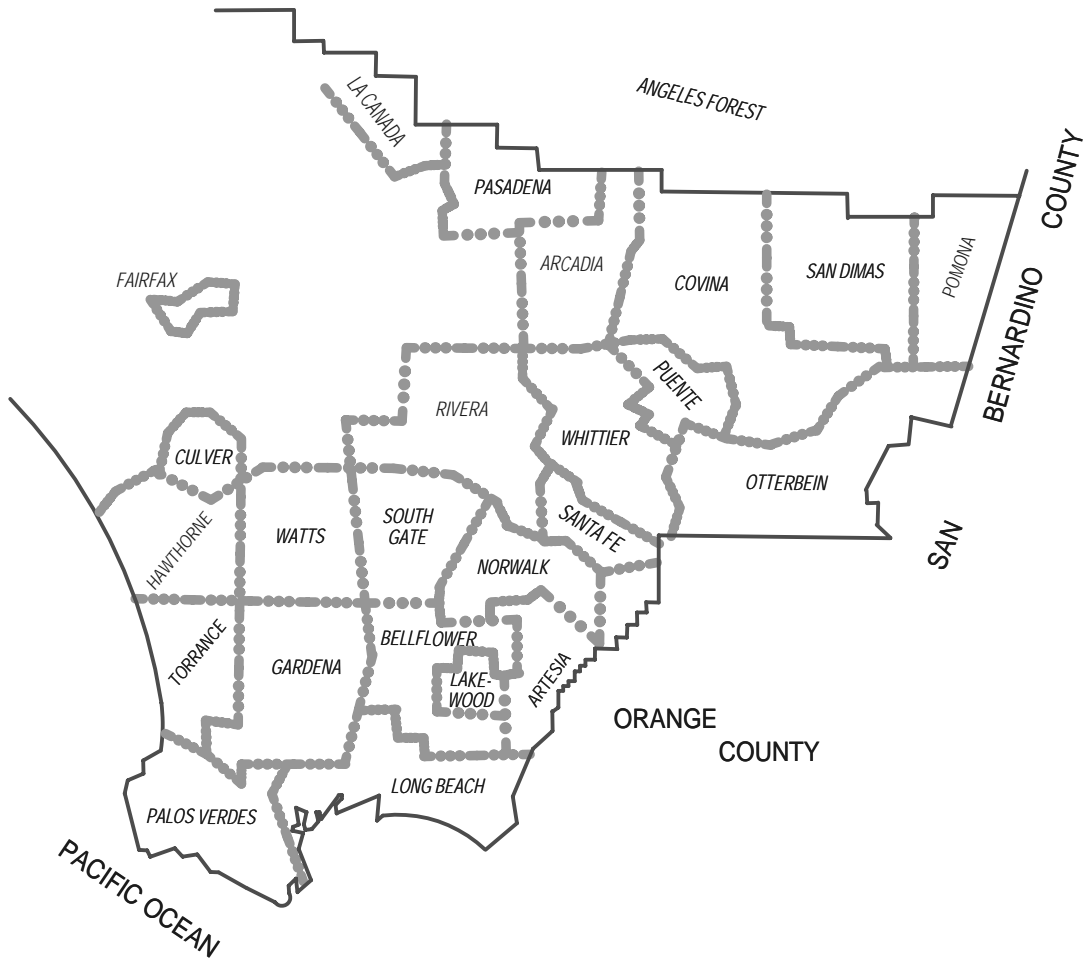
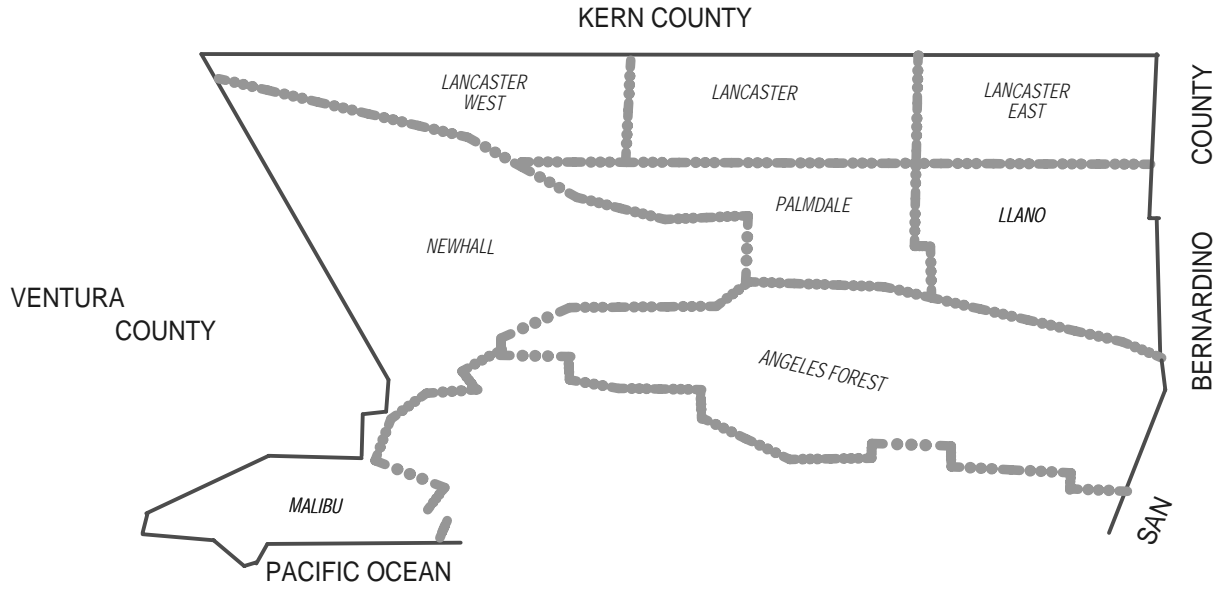

POMONA QUAD INDEX

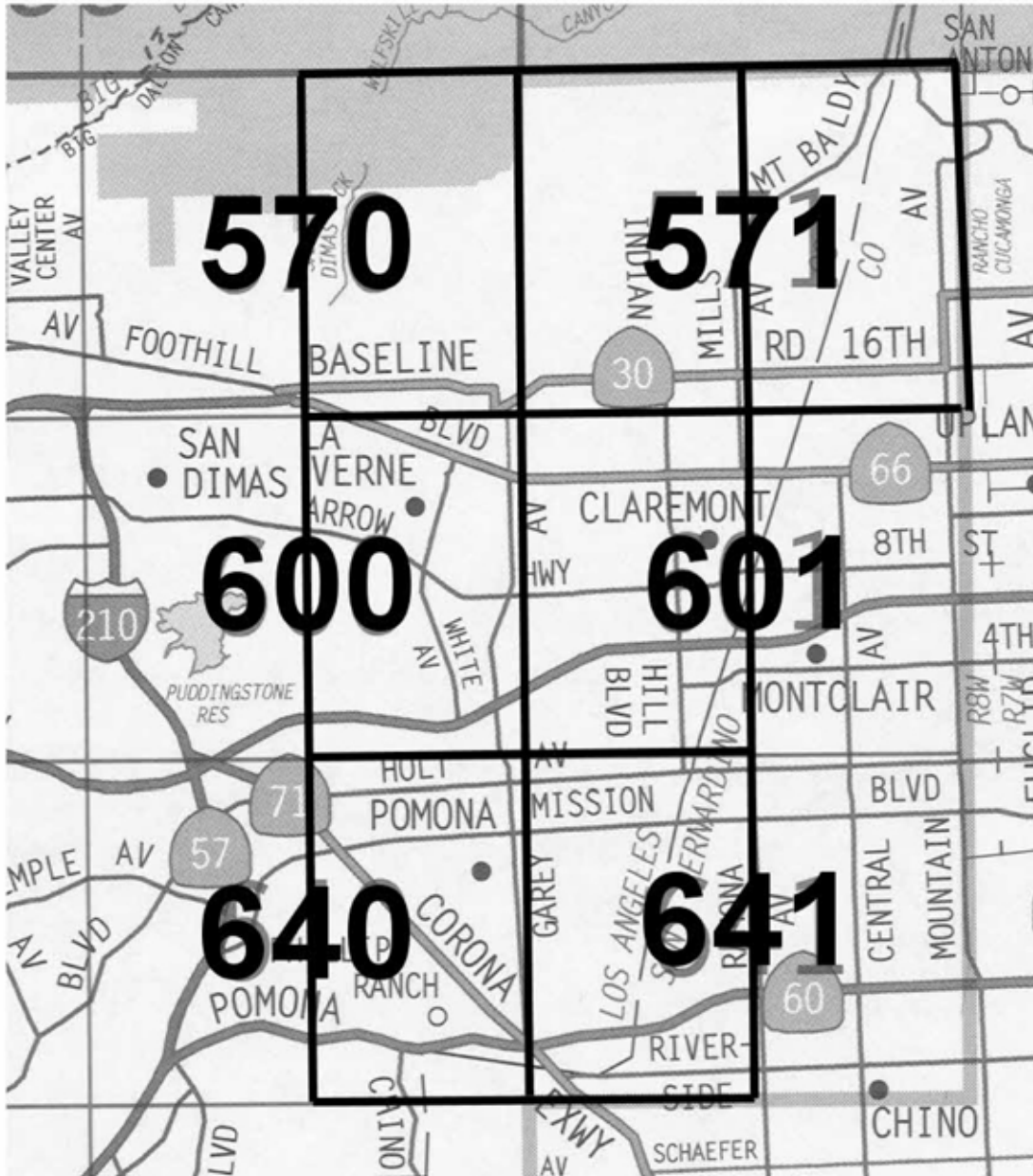

**NUMBERS REFER TO
THOMAS BROS PAGE
NUMBERS.**

**EACH THOMAS BROS
PAGE IS DIVIDED INTO
TWO INDEX PAGES
EAST AND WEST**

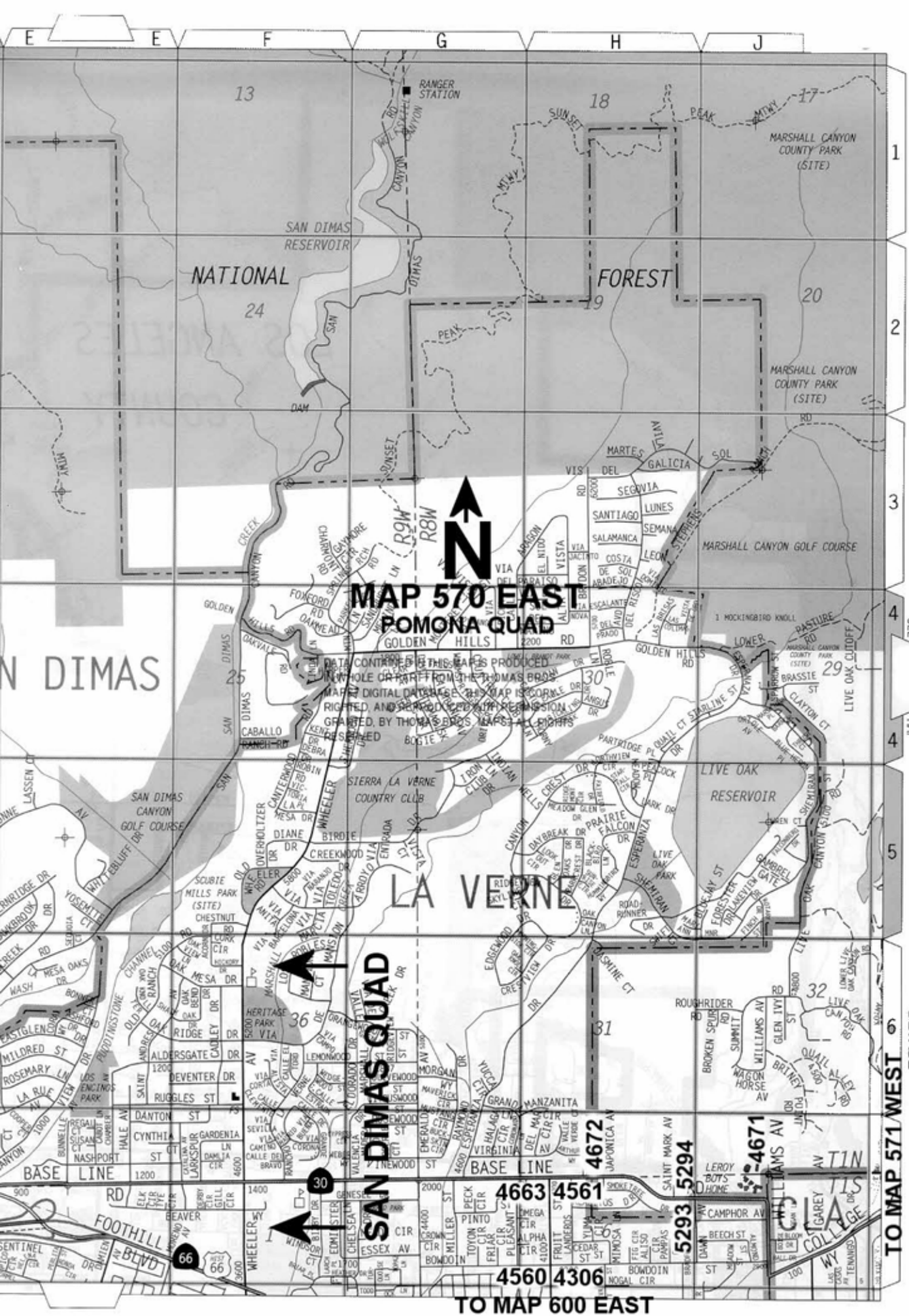

NATIONAL

FOREST

MAP 570 EAST POMONA QUAD

DATA CONTAINED IN THIS MAP IS PRODUCED BY WHOLE OR PART FROM THE THOMAS BROS. MAPS DIGITAL DATABASE. THIS MAP IS COPYRIGHTED AND REPRODUCED WITH PERMISSION GRANTED BY THOMAS BROS. MAPS. ALL RIGHTS RESERVED.

SAN DIMAS QUAD

TO MAP 600 EAST

TO MAP 571 WEST

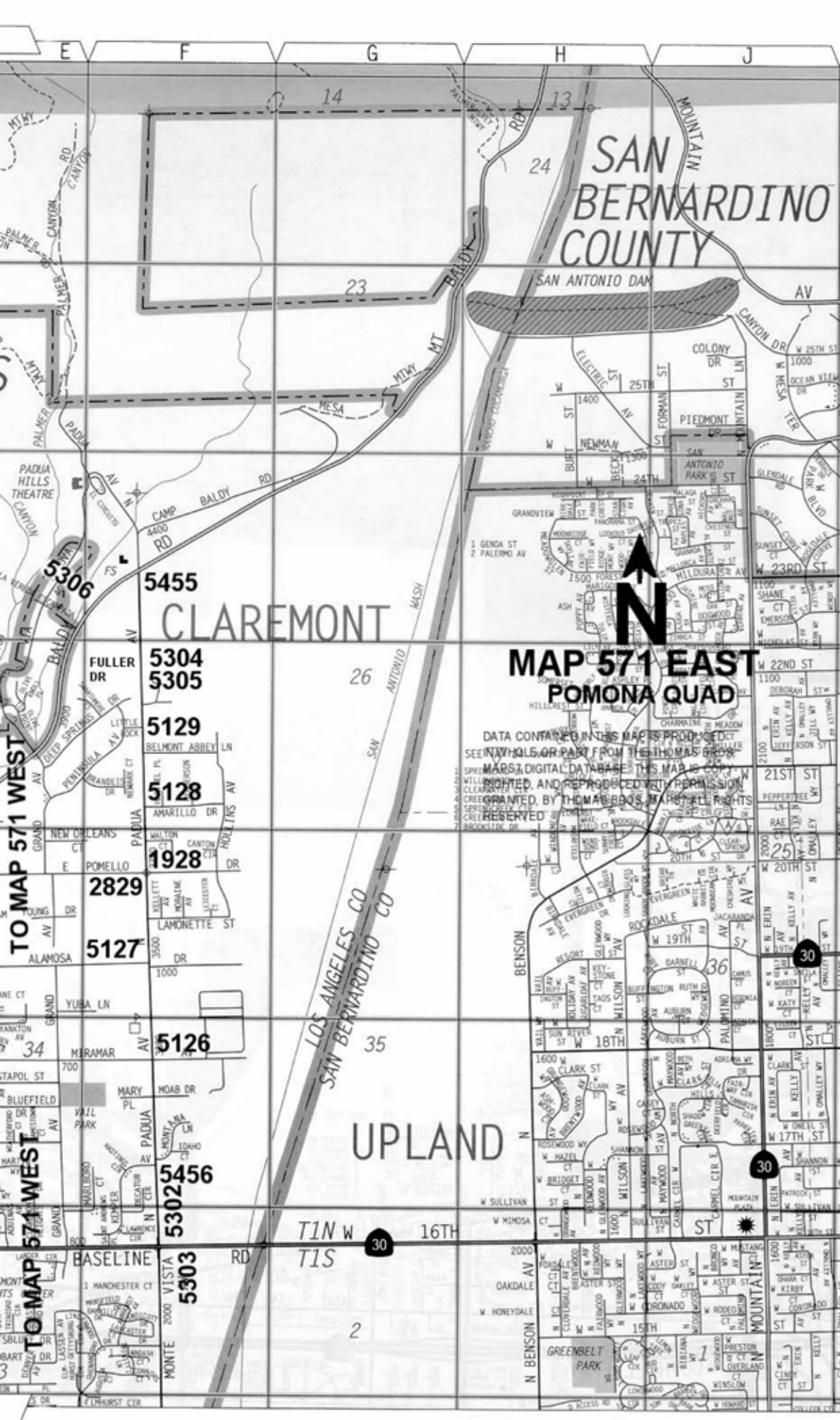

SAN BERNARDINO COUNTY

MAP 571 EAST POMONA QUAD

CLAREMONT

26

35

UPLAND

TO MAP 571 WEST

TO MAP 574 WEST

DATA CONTAINED IN THIS MAP IS PRODUCED BY THOMAS BROS. MAPS, A DIGITAL DATABASE. THIS MAP IS COPYRIGHTED AND REPRODUCED WITH PERMISSION GRANTED BY THOMAS BROS. MAPS. ALL RIGHTS RESERVED.

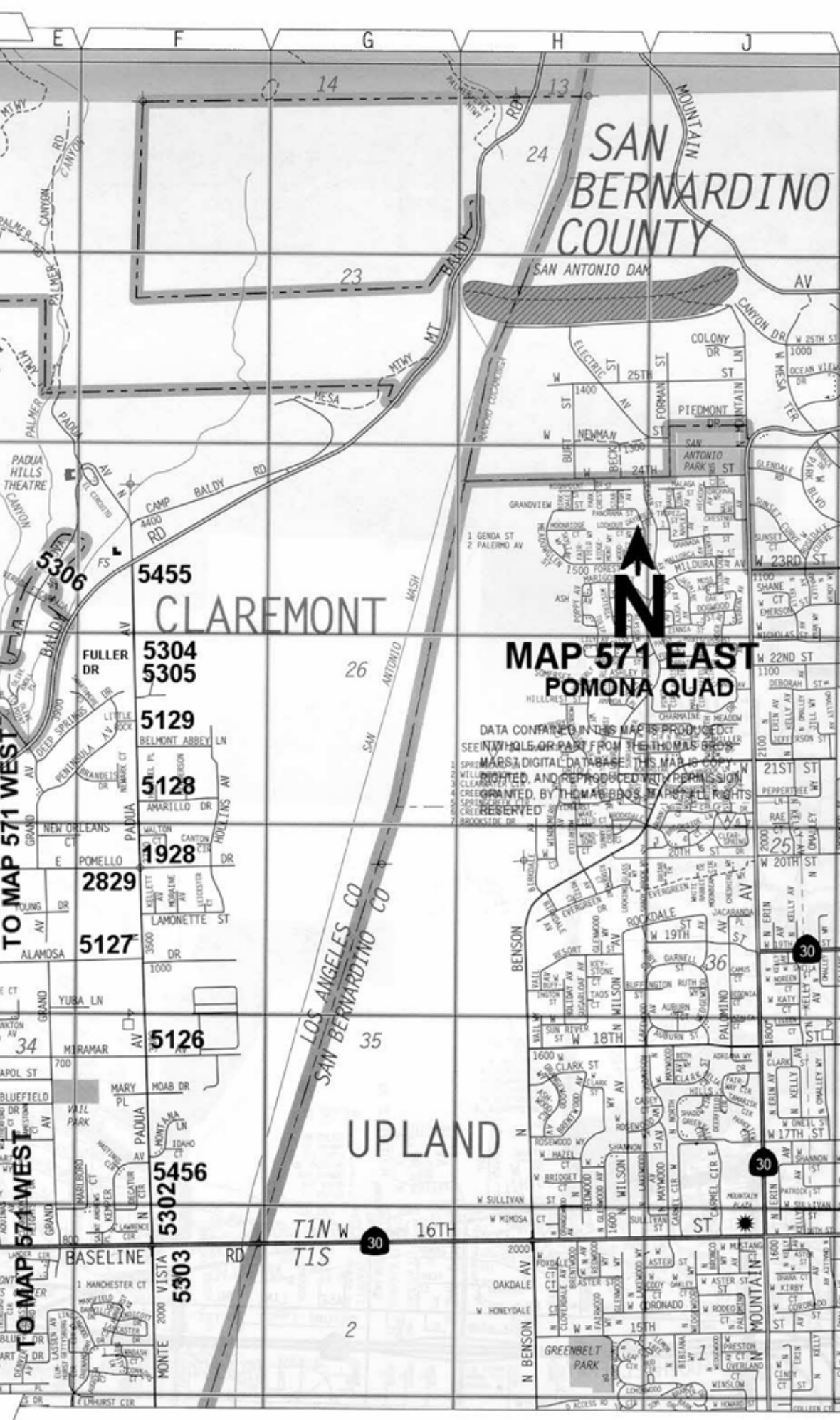

SAN BERNARDINO COUNTY

MAP 571 EAST POMONA QUAD

CLAREMONT

26

35

UPLAND

TO MAP 571 WEST

TO MAP 574 WEST

DATA CONTAINED IN THIS MAP IS PRODUCED BY THOMAS BROS. MAPS, A DIGITAL DATABASE. THIS MAP IS COPYRIGHTED AND REPRODUCED WITH PERMISSION GRANTED BY THOMAS BROS. MAPS. ALL RIGHTS RESERVED.



**MAP 571 WEST
POMONA QUAD**

DATA CONTAINED IN THIS MAP IS PRODUCED IN WHOLE OR PART FROM THE THOMAS BROS. MAPS7 DIGITAL DATABASE. THIS MAP IS COPYRIGHTED, AND REPRODUCED WITH PERMISSION GRANTED, BY THOMAS BROS. MAPS. ALL RIGHTS RESERVED

2825
2826

5130

5131

4563

5295

5296

5298

5288

4314

5299

5137

5301

5300

5123

3780

4668

2815

5122

5121

4319

5297

5299

5298

5288

4314

5299

5137

5301

5300

5123

3780

4668

2815

5122

5297

5299

5298

5288

4314

5299

5137

5301

5300

5123

3780

4668

2815

5122

5297

5299

5298

5288

4314

5299

5137

5301

5300

5123

3780

4668

2815

5122

5297

5299

5298

5288

4314

5299

5137

5301

5300

5123

3780

4668

2815

5122

5297

5299

5298

5288

4314

5299

5137

5301

5300

5123

3780

4668

2815

5122

TO MAP 601 WEST

TO MAP 601 WEST

TO MAP 570 EAST

TO MAP 571 EAST

TO MAP 574 EAST



MAP 600 EAST POMONA QUAD

DATA CONTAINED IN THIS MAP IS PRODUCED IN WHOLE OR PART FROM THE THOMAS BROS MAPS 7 DIGITAL DATABASE. THIS MAP IS COPY RIGHTED, AND REPRODUCED WITH PERMISSION GRANTED, BY THOMAS BROS. MAPS. ALL RIGHTS RESERVED.

VERNE

SAN DIMAS QUAD

POMONA



- SEE V J1
- 1 VALLEY OAK
 - 2 CANYON OAK CIR
 - 3 WHITE OAK DR
 - 4 MESA OAK LN

TO MAP 571 WEST

TO MAP 600 EAST

TO MAP 600 EAST

TO MAP 641 WEST

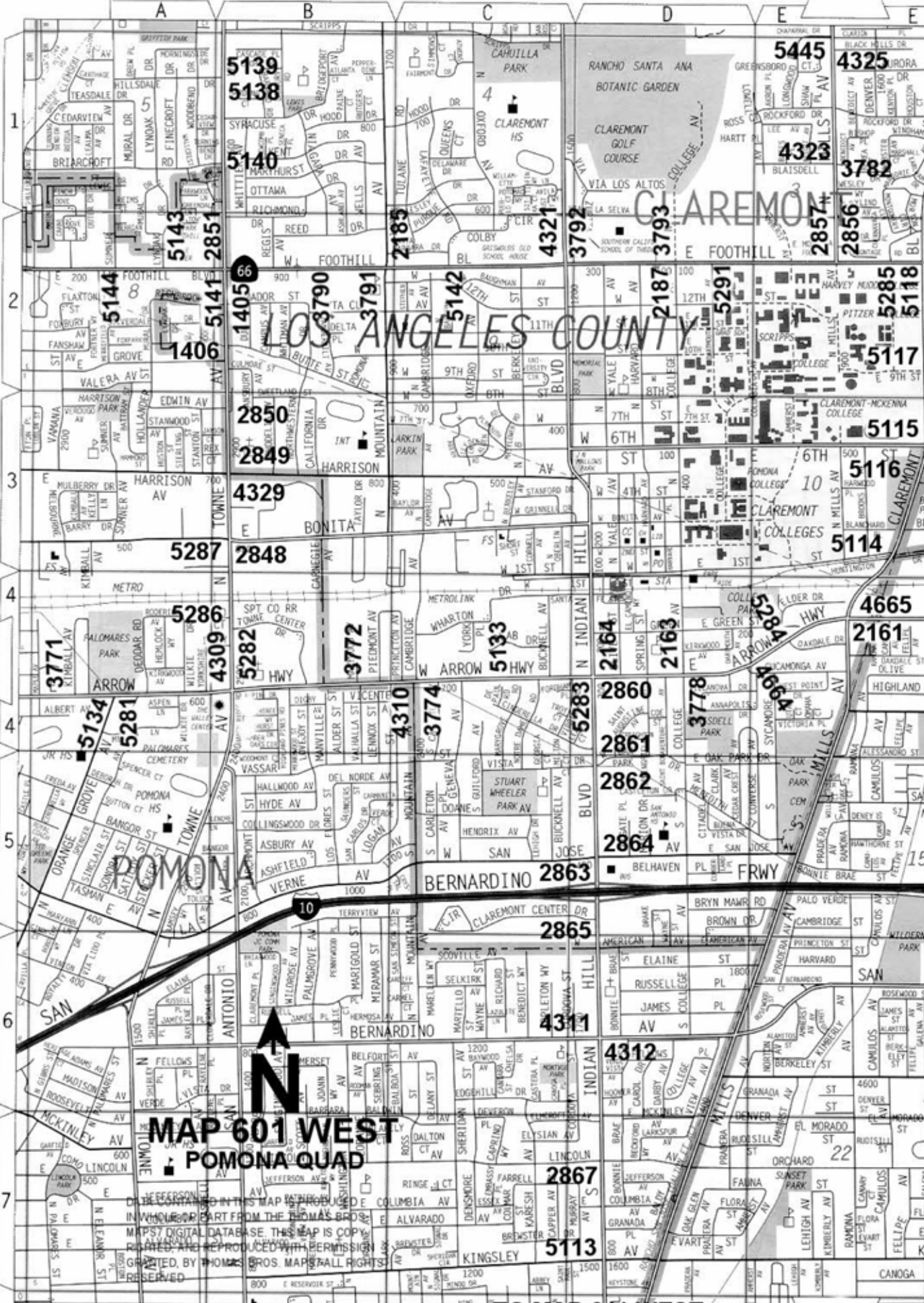

MAP 601 WEST
POMONA QUAD

NOT CONTAINED IN THIS MAP IS REPRODUCED IN WHOLE OR PART FROM THE THOMAS BROS. MAPS DIGITAL DATABASE. THIS MAP IS COPYRIGHTED AND REPRODUCED WITH PERMISSION GRANTED BY THOMAS BROS. MAPS. ALL RIGHTS RESERVED.

TO MAP 641 WEST

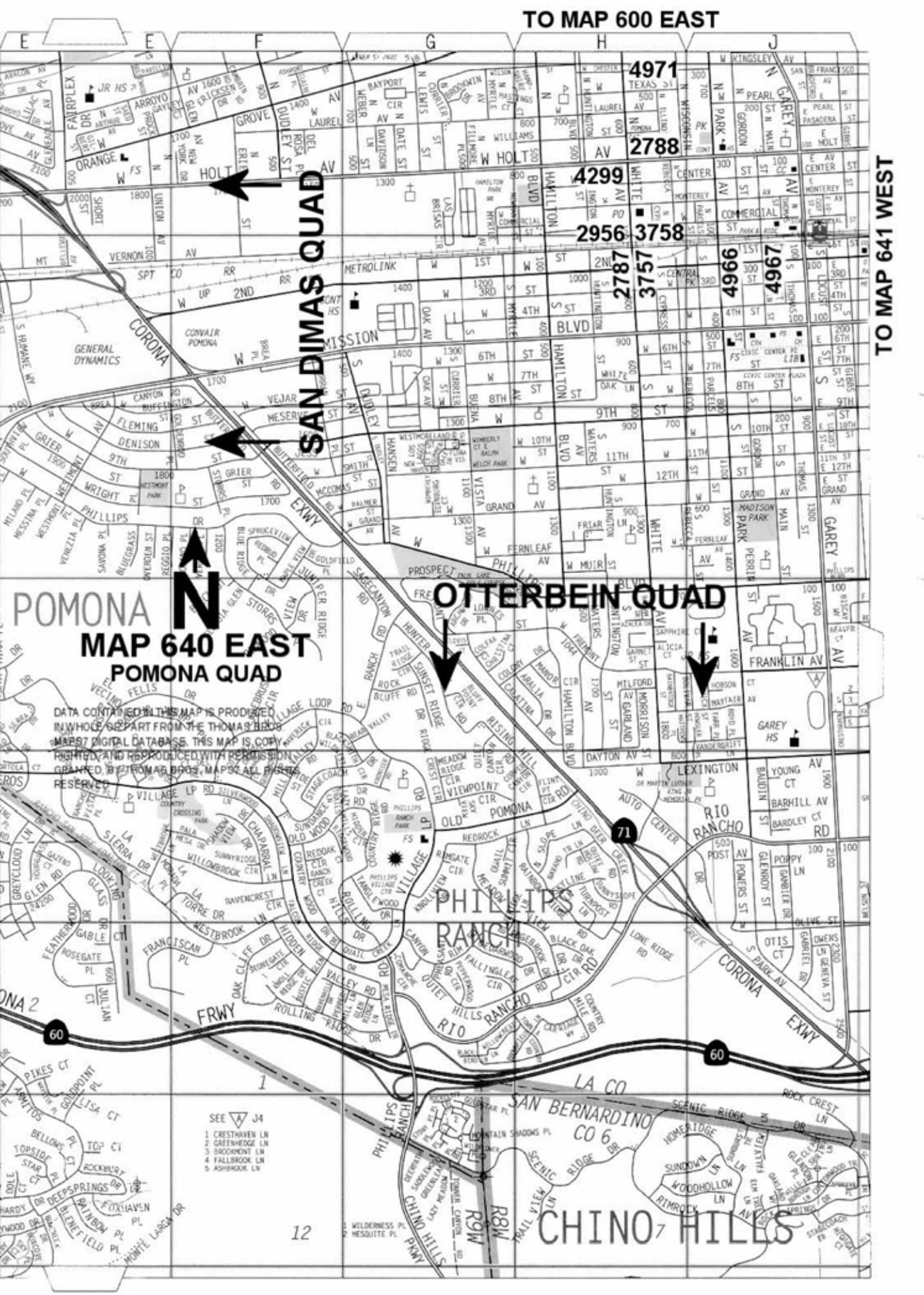

SAN DIMAS QUAD

OTTERBEIN QUAD

**MAP 640 EAST
POMONA QUAD**

DATA CONTAINED IN THIS MAP IS PRODUCED IN WHOLE OR PART FROM THE THOMAS BROS. MAPS DIGITAL DATABASE. THIS MAP IS COPY RIGHTED AND REPRODUCED WITH PERMISSION GRANTED BY THOMAS BROS. MAPS. ALL RIGHTS RESERVED.

SEE ∇ J4
 1 CRESTHAVEN LN
 2 GARDENEDGE LN
 3 SADDLEPOINT LN
 4 FALLBROOK LN
 5 ASHBROOK LN

TO MAP 601 WEST

TO MAP 640 EAST



OTTERBEIN QUAD

POMONA

SAN BERNARDINO

**MAP 641 WEST
POMONA QUAD**



DATA CONTAINED IN THIS MAP IS PRODUCED
 BY WHOLE OR PART FROM THE THOMAS BROS.
 MAP PHILADELPHIA BASE THIS MAP'S COPY.

PRINTED AND REPRODUCED WITH PERMISSION
 GRANTED BY THOMAS BROS. MAPS ALL RIGHTS
 RESERVED.

CHINO HILLS

RIVERSIDE

SAN ANTONIO

MCKINLEY

COZZENS AV

PAMELA DR

MACLENA

BISCAYNE

WALNUT

QUAD YEAR	ELEV FOOT/METER	DESCRIPTION	BM NUMBER
POMONA (2005)	1,198.480 365.298	L&T IN CB RET 4.5M(14.7FT) W/O BCR @ SE COR TOWNE AVE & FOOTHILL BLVD	G 1405
POMONA (2005)	1,177.647 358.948	L&BN IN E CB (SERV RD) 600MM(2FT) N/O BCR @ NE COR TOWNE AVE & BUTTE ST	G 1406
POMONA (2005)	1,688.499 514.656	RDBM TAG IN BRICK BASE OF FENCE 600MM(2FT) W/O COR 6M(20FT) S/O & 10M(32.8FT) W/O C/L INT PADUA AVE & POMELLO DR	G 1928
BASELINE (2005)	1,155.813 352.293	L&BN IN S CB 300MM(1FT) E/O BCR @ SE COR MILLS AVE & ARROW HWY 24M(78.7FT) E/O & 9M(29.5FT) S/O C/L INT	G 2161
BASELINE (2005)	1,110.675 338.535	L&PK IN W CB 16M(52.5FT) N/O BCR @ NW COR ARROW HWY & COLLEGE AVE 27M(88.6FT) N/O & 8M(26.2FT) W/O C/L INT	G 2163
BASELINE (2005)	1,112.236 339.011	RDBM TAG IN S CB ARROW HWY 12M(39.4FT) S/O C/L & 64M(210FT) E/O C/L INDIAN HILL BLVD	G 2164
POMONA (2005)	1,046.061 318.840	L&BR IN E CB RET 600MM(2FT) N/O BCR @ SE COR ARROW HWY & MAPLE AVE 23M(75.5FT) S/O & 5.5M(18FT) E/O C/L INT	G 2171
POMONA (2005)	1,041.066 317.318	RDBM TAG IN S CB 300MM(1FT) E/O BCR @ SE COR ARROW HWY & GAREY AVE 18M(59FT) E/O & 12M(39.4FT) S/O C/L INT	G 2172
BASELINE (2005)	1,084.195 330.464	CSBM MON IN WELL 600MM(2FT) N/O CF 4M(13FT) W/O BCR @ NW COR WHITE AVE & 7TH ST 13M(42.7FT) W/O & 5.5M(18FT) N/O C/L INT MKD (BM 13-8 1952 RE 63)	G 2182
BASELINE (2005)	1,066.118 324.954	L&BN IN W CB 2M(6.5FT) S/O BCR @ SW COR WHITE AVE & BONITA AVE 21.5M(70.5FT) S/O & 7.5M(24.6FT) W/O C/L INT	G 2183
POMONA (2005)	1,233.438 375.953	BT SPK IN E CB N END C B @ NE COR MOUNTAIN AVE & FOOTHILL BLVD MKD (SD 515)	G 2185
POMONA (2005)	1,284.727 391.586	L&PK IN N CB 3M(10FT) W/O BCR @ NW COR COLLEGE AVE & FOOTHILL BLVD	G 2187
BASELINE (2005)	848.271 258.554	L&BN IN E CB 300MM(1FT) N/O BCR @ NE COR WHITE AVE & 2ND ST 18.5M(60.6FT) N/O & 13M(42.7FT) E/O C/L INT	G 2787
BASELINE (2005)	860.388 262.247	CSBM MON IN WELL 175MM(0.6FT) DN IN GUTTER 5M(16.4FT) E/O BCR @ SW COR WHITE AVE & HOLT AVE 17M(56FT) W/O & 11M(36FT) S/O C/L INT MKD (BM 13-1 1952)	G 2788
POMONA (2005)	1,035.083 315.494	L&T IN N CB ARROW HWY 13M(42.7FT) N/O C/L ON C/L PROD FAIR AVE & HOLT AVE	G 2796
BASELINE (2005)	1,104.733 336.724	L&BN IN E CB 300MM(1FT) S/O BCR @ SE COR WHITE AVE & KENDALL ST 15M(49.2FT) S/O & 12M(39.4FT) E/O C/L INT	G 2798
BASELINE (2005)	1,141.969 348.073	BT SPK IN W CB 18.5M(60.7FT) N/O BCR @ NW COR FRUIT ST & FOOTHILL BLVD 43M(141FT) N/O & 12M(39.4FT) W/O C/L INT	G 2801
POMONA (2005)	1,421.769 433.356	L&T IN S CB OF DRWY TO HSE #2258 INDIAN HILL BLVD 19M(62.3) E/O C/L & 76M(249FT) S/O C/L SAN LUIS PL	G 2815
POMONA (2005)	1,662.964 506.873	L&BN IN SE LEG CONC BASE OF TOWER #228-D6 133M(436FT) E/O & 24M(78.7FT) N/O C/L INT MILLS AVE & MT BALDY RD	G 2824

QUAD YEAR	ELEV FOOT/METER	DESCRIPTION	BM NUMBER
POMONA (2005)	1,689.791 515.050	L&BN IN SE CONC BASE OF TOWER #228-D5 25M(82FT) N/O & 17M(56FT) W/O C/L INT MT BALDY RD & VIA PADOVA	G 2825
POMONA (2005)	1,692.731 515.946	L&BN IN N END ROCK WALL 16M(52.5FT) N/O & 7.5M(24.6FT) W/O C/L INT MT BALDY RD & VIA PADOVA	G 2826
POMONA (2005)	1,688.112 514.538	RDBM TAG IN E CB 1M(3.3FT) S/O BCR @ SE COR PADUA AVE & PAMELLO DR	G 2829
BASELINE (2005)	1,421.391 433.241	RDBM TAG IN S CB BASELINE RD 12M(39.4FT) S/O C/L & 17M(56FT) W/O C/L PROD FORBES AVE	G 2836
POMONA (2005)	1,116.189 340.215	L&PK IN W CB 600MM(2FT) S/O BCR @ SW COR TOWNE AVE & BONITA AVE	G 2848
POMONA (2005)	1,137.788 346.799	L&PK IN N CB 2M(6.5FT) W/O BCR @ NW COR TOWNE AVE & HARRISON AVE	G 2849
POMONA (2005)	1,155.969 352.340	RDBM TAG IN W CB 300MM(1FT) S/O BCR @ SW COR TOWNE AVE & EDWIN AVE	G 2850
POMONA (2005)	1,196.735 364.766	CS MON IN WELL @ SE COR FOOTHILL BLVD & TOWNE AVE 20M(65.6FT) S/O & 15.5M(51FT) E/O C/L INT MKD (RM 5 RE 5869 1961)	G 2851
BASELINE (2005)	1,309.597 399.166	L&PK IN N CB 1.5M(5FT) E/O BCR @ NE COR FOOTHILL BLVD & MILLS AVE 15M(49.2FT) E/O & 13.5M(44FT) N/O C/L INT	G 2856
BASELINE (2005)	1,306.765 398.303	RDBM TAG IN S CB 300MM(1FT) W/O BCR @ SW COR FOOTHILL BLVD & MILLS AVE 13.5M(44FT) S/O & 17M(56FT) W/O C/L INT	G 2857
BASELINE (2005)	1,109.557 338.194	L&T IN E CB 300MM(1FT) N/O BCR @ SE COR INDIAN HILL BLVD & ARROW HWY 22M(72FT) S/O & 13M(42.7FT) E/O C/L INT	G 2860
BASELINE (2005)	1,079.028 328.889	L&PK IN W CB 1.5M(5FT) N/O BCR @ NW COR INDIAN HILL BLVD & VISTA DR 18M(59FT) N/O & 10.5M(34.4FT) W/O C/L INT	G 2861
BASELINE (2005)	1,075.728 327.883	RDBM TAG IN W CB 300MM(1FT) S/O BCR @ SW COR INDIAN HILL BLVD & VISTA DR 16M(52.5FT) S/O & 10.5M(34.4FT) W/O C/L INT	G 2862
BASELINE (2005)	1,047.385 319.244	RDBM TAG IN W CB 300MM(1FT) N/O BCR @ NW COR INDIAN HILL BLVD & SAN JOSE AVE 17M(56FT) N/O & 12M(39.4FT) W/O C/L INT	G 2863
BASELINE (2005)	1,044.589 318.392	RDBM TAG IN E CB 300MM(1FT) S/O BCR @ SE INDIAN HILL BLVD & SAN JOSE AVE 19M(62.3FT) S/O & 12M(39.4FT) E/O C/L INT	G 2864
BASELINE (2005)	1,019.403 310.715	L&PK IN S CB 3.5M(11.5FT) E/O BCR @ SE COR AMERICAN AVE & INDIAN HILL BLVD 24M(78.7FT) E/O & 5M(16.4FT) S/O C/L INT	G 2865
BASELINE (2005)	966.306 294.531	L&PK IN W CB 1M(3.3FT) N/O BCR @ NW COR INDIAN HILL BLVD & LINCOLN AVE 14M(46FT) N/O & 10.5M(34.4FT) W/O C/L INT	G 2867
BASELINE (2005)	922.886 281.297	L&PK IN N CB 300MM(1FT) E/O BCR @ NE COR INDIAN HILL BLVD & HOLT AVE 22M(72FT) E/O & 12M(39.4FT) N/O C/L INT	G 2869
BASELINE (2005)	922.110 281.060	RDBM TAG IN N CB 300MM(1FT) W/O BCR @ NW COR HOLT AVE & INDIAN HILL BLVD 20M(65.6FT) W/O & 12M(39.4FT) N/O C/L INT	G 2870
POMONA (2005)	914.894 278.861	L&T IN S CB 100MM(0.3FT) E/O BCR @ SE COR EAST END AVE & HOLT AVE 21.5M(70.5FT) E/O & 12M(39.4FT) S/O C/L INT	G 2871

QUAD YEAR	ELEV FOOT/METER	DESCRIPTION	BM NUMBER
BASELINE (2005)	914.078 278.612	L&T IN W CB 1M(3.3FT) N/O BCR @ SW COR HOLT AVE & EAST END AVE 24.5M(80.4FT) S/O & 10.5M(34.4FT) W/O C/L INT	G 2872
BASELINE (2005)	900.251 274.397	CSBM MON FL 300M(1FT) S/O CF & 2.5M(8.2FT) W/O BCR @ SW COR 1ST ST & EAST END AVE 26M(85.3FT) W/O & 6.5M(21.3FT) S/O C/L INT MKD (11-77-A 1959 RE 5869)	G 2874
BASELINE (2005)	877.295 267.400	CSBM MON @ SW ABUT OF BRIDGE OVER TOWNE AVE 15.5M(51FT) W/O C/L & 8M(26.2FT) S/O C/L 1ST ST MKD (BM 11-79A 1962 RE 5869)	G 2878
BASELINE (2005)	852.790 259.931	CSBM MON IN HDWL 2M(6.5FT) S/O CF @ W END OF BRIDGE OVER WHITE AVE 26M(85FT) W/O C/L & 8M(26.2FT) S/O C/L 1ST ST MKD (BM 11-83A 1962 RE 5869)	G 2956
POMONA (2005)	1,166.467 355.540	L&N IN W CB 14M(46FT) S/O BCR @ SW COR FOOTHILL BLVD & GAREY AVE	G 2977
BASELINE (2005)	1,039.018 316.694	RDBM TAG IN W CB WHITE AVE 300MM(1FT) N/O BCR 12M(39.4FT) W/O C/L & 18M(59FT) S/O C/L ARROW HWY	G 3451
BASELINE (2005)	848.036 258.482	RDBM TAG IN W CB 600MM(2FT) S/O BCR @ SW COR 2ND ST & WHITE AVE 20M(65.5FT) S/O & 10M(32.8FT) W/O C/L INT	G 3757
BASELINE (2005)	853.437 260.128	RDBM TAG IN S CB @ SE COR OF BRIDGE OVER WHITE AVE 23.5M(77FT) E/O C/L & 6M(19.7FT) S/O C/L 1ST ST	G 3758
BASELINE (2005)	876.830 267.259	L&PK @ SE ABUT OF BRIDGE OVER TOWNE AVE 24M(79FT) E/O C/L & 8M(26.2FT) S/O C/L 1ST ST	G 3763
BASELINE (2005)	890.315 271.369	RDBM IN S CB 1ST ST 6M(19.7FT) S/O C/L @ E P/L WATER RESERVOIR 87M(285FT) E/O ELECTRA ST	G 3767
POMONA (2005)	1,033.335 314.961	FC MON IN E END C B @ NE COR ARROW HWY & FULTON RD 14M(46FT) N/O & 22M(72FT) E/O C/L INT MKD (BM 105-00770 1966)	G 3769
POMONA (2005)	1,033.040 314.872	RDBM TAG IN E CB 300MM(1FT) N/O BCR @ SE COR ARROW HWY & GLENCOE WAY 22M(72FT) S/O & 5.5M(18FT) E/O C/L INT	G 3770
POMONA (2005)	1,050.377 320.156	L&T IN S CB ARROW HWY 13M(42.7FT) S/O C/L ON C/L PROD KIMBALL AVE	G 3771
POMONA (2005)	1,088.234 331.695	L&T IN S CB 12M W/O BCR @ SW COR ARROW HWY & VALHALLA ST 30.5M W & 13M S/O C/L INT	G 3772
POMONA (2005)	1,095.142 333.800	RDBM TAG IN S CB 300MM(1FT) E/O BCR @ SE COR ARROW HWY & MOUNTAIN AVE 17M(56FT) E/O & 13M(42.7FT) S/O C/L INT	G 3774
BASELINE (2005)	1,109.665 338.227	RDBM TAG IN E CB 2M(6.5FT) N/O BCR @ NE COR ARROW HWY & COLLEGE AVE 14M(46FT) N/O & 7.5M(24.6FT) E/O C/L INT	G 3778
BASELINE (2005)	1,396.657 425.702	USC&GS MON IN NW CB RET 1M(3.3FT) E/O BCR @ BASELINE RD & INDIAN HILL BLVD 19M(62.3FT) W/O & 12M(39.4FT) N/O C/L INT MKD (D 36 RESET 1967)	G 3780
BASELINE (2005)	1,356.577 413.486	L&PK IN W CB 300MM N/O BCR @ NW COR MILLS AVE & BLAISDELL DR 18M N & 10.5M W/O C/L INT	G 3782

QUAD YEAR	ELEV FOOT/METER	DESCRIPTION	BM NUMBER
POMONA (2005)	1,217.087 370.969	RDBM TAG IN N CB FOOTHILL BLVD 11.5M(37.7FT) N/O C/L & 168M(550FT) E/O C/L REGIS ST (23M(75.5FT) E/O BLDG #973)	G 3790
POMONA (2005)	1,232.815 375.763	RDBM TAG IN S CB 11M(36FT) E/O BCR @ SE COR FOOTHILL BLVD & MOUNTAIN AVE (@ C. B.)	G 3791
POMONA (2005)	1,259.548 383.911	RDBM TAG IN E CB 1.5M(5FT) N/O BCR @ NE COR FOOTHILL BLVD & INDIAN HILL BLVD	G 3792
POMONA (2005)	1,282.769 390.989	RDBM TAG IN S CB 1M(3.3FT) W/O BCR @ SW COR FOOTHILL BLVD & COLLEGE AVE	G 3793
POMONA (2005)	1,044.667 318.415	RDBM TAG IN E CB 18M(59FT) N/O BCR @ NE COR ARROW HWY & GAREY AVE 44M(144FT) N/O & 12M(39.4FT) E/O C/L INT	G 3798
BASELINE (2005)	1,040.546 317.159	L&T IN CTR CB RET @ NW COR WHITE AVE & ARROW HWY 21.5M(70.5FT) W/O & 17M(55.8FT) N/O C/L INT	G 4293
BASELINE (2005)	861.704 262.648	RAMSET IN E/O CB 5M(16.4FT) S/O BCR @ SE COR WHITE AVE & HOLT AVE 26.5M(86.9FT) S/O & 10.5M(34.4FT) E/O C/L INT	G 4299
BASELINE (2005)	889.332 271.069	L&PK NAIL IN CTR OF CB RET @ NE COR WHITE AVE & ORANGE GROVE AVE 16.5M(54FT) E/O & 14M(46FT) N/O C/L INT	G 4300
BASELINE (2005)	936.190 285.352	PK IN E CB 300MM(1FT) N/O BCR @ SE COR WHITE AVE & MC KINLEY AVE 21.5M(70.5FT) S/O & 17M(55.8FT) E/O C/L INT	G 4301
BASELINE (2005)	937.863 285.862	FC BR DISC IN W END HDWL OF FC CHANNEL @ NW COR MC KINLEY AVE & WHITE AVE 34M(111FT) W/O & 11M(36FT) N/O C/L INT MKD (BM 105-00005)	G 4302
BASELINE (2005)	1,104.885 336.770	L&T IN W CB WHITE AVE 12M(39.4FT) W/O C/L & 7.5M(24.6FT) S/O C/L PROD KENDALL ST	G 4303
BASELINE (2005)	1,163.118 354.519	RDBM TAG IN W CB 600MM(2FT) S/O BCR @ SW COR FRUIT ST & BOWDOIN ST 16.5M(54FT) S/O & 13M(43FT) W/O C/L INT	G 4306
POMONA (2005)	1,034.788 315.404	L&PK NAIL IN S CB ARROW HWY 300MM(1FT) W/O BCR 13M(42.7FT) S/O C/L & 15M(49FT) W/O C/L FAIR AVE	G 4307
POMONA (2005)	1,073.064 327.071	PK NAIL IN N CB 6.5M(21.3FT) E/O BCR @ NE COR ARROW HWY & TOWNE AVE 30.5M(100FT) E/O & 13M(42.7FT) N/O C/L INT	G 4309
POMONA (2005)	1,093.801 333.392	PK NAIL IN W CB 300MM(1FT) S/O BCR @ SW COR MOUNTAIN AVE & ARROW HWY 22M(72FT) S/O & 6M(19.7FT) W/O C/L INT	G 4310
BASELINE (2005)	993.232 302.738	RDBM TAG IN E CB 300MM(1FT) S/O BCR @ SE COR INDIAN HILL BLVD & SAN BERNARDINO AVE 18.5M(60.7FT) S/O & 10.5M(34.4FT) E/O C/L INT	G 4311
BASELINE (2005)	995.904 303.552	RDBM TAG IN E CB 300MM(1FT) N/O BCR @ NE COR INDIAN HILL BLVD & SAN BERNARDINO AVE 18M(59FT) N/O & 10.5M(34.4FT) E/O C/L INT	G 4312
BASELINE (2005)	1,308.063 398.699	RDBM TAG IN NW COR WEIR BOX 4M(13FT) E/O & 59M(194FT) N/O C/L INT TOWNE AVE & BASELINE RD	G 4314
BASELINE (2005)	1,470.114 448.092	FC MON IN WELL 600MM(2FT) S/O C/L BASELINE RD & 600MM(2FT) W/O C/L MILLS AVE MKD (LAFD DIST)	G 4319

QUAD YEAR	ELEV FOOT/METER	DESCRIPTION	BM NUMBER
POMONA (2005)	1,259.015 383.749	NAIL IN CB RET 300MM(1FT) S/O BCR @ NW COR FOOTHILL BLVD & INDIAN HILL BLVD	G 4321
BASELINE (2005)	1,354.973 412.997	RCE TAG #9009 IN S CB 1.5M(5FT) W/O BCR @ SE COR MILLS AVE & BLAISDELL DR 19M(62.3FT) E/O & 6M(19.7FT) S/O C/L INT	G 4323
BASELINE (2005)	1,407.543 429.020	RCE TAG #7344 IN E CB 1.5M(5FT) N/O BCR @ NE COR MILLS AVE & BLACK HILLS DR 15M(49.2FT) N/O & 10M(33FT) E/O C/L INT	G 4325
POMONA (2005)	1,623.044 494.705	RDBM TAG IN NW COR CONC BASE PP #1822460E 7.5M(24.6FT) S/O & 6.5M(21.3FT) E/O C/L INT POMELLO DR & MILLS AVE	G 4326
POMONA (2005)	1,488.292 453.633	RDBM TAG IN W CB FORBES AVE 4.5M(14.8FT) W/O C/L & 25M(82FT) S/O C/L MIRAMAR AVE @ ENT WALK TO SCHOOL	G 4327
POMONA (2005)	1,449.312 441.752	RDBM TAG IN W CB 1.5M(5FT) S/O BCR @ SW COR CARMEL DR & INDIAN HILL BLVD	G 4328
POMONA (2005)	1,136.115 346.289	RDBM TAG IN W CB 300MM(1FT) S/O BCR @ SW COR TOWNE AVE & HARRISON AVE	G 4329
BASELINE (2005)	1,165.534 355.256	RDBM TAG IN E CB 300MM(1FT) N/O BCR @ NE COR FRUIT ST & BOWDOIN ST 18M(59FT) N/O & 13M(42.7FT) E/O C/L INT	G 4560
BASELINE (2005)	1,174.345 357.941	RDBM TAG IN S CB 300MM(1FT) W/O BCR @ SW COR BASELINE RD & FRUIT ST 24M(79FT) W/O & 13M(42.7FT) S/O C/L INT	G 4561
POMONA (2005)	1,548.477 471.977	L&PK IN E CB @ BCR SE COR MILLS AVE MIRAMIR AVE	G 4563
POMONA (2005)	1,550.555 472.611	L&BR IN S CB 300MM(1FT) W/O BCR @ SW COR MILLS AVE & MIRAMAR AVE	G 4564
POMONA (2005)	1,523.109 464.245	RDBM TAG IN S CB 300MM(1FT) W/O BCR @ SW COR MIRAMAR AVE & BONNIE BRAE AVE	G 4565
BASELINE (2005)	899.222 274.084	DPW BM TAG IN E CB 1.5M(4.9FT) S/O BCR @ SE COR 1ST ST & EAST END AVE 18.5M(60FT) S/O & 12M(39.4FT) E/O C/L INT	G 4643
BASELINE (2005)	964.939 294.114	L&PK IN HDWL @ SE COR BRIDGE OVER THOMPSON CREEK 15.5M(50.9FT) E/O C/L WHITE AVE & 45M(148FT) S/O C/L DRWY ENT GATE #5 (483M(0.3MI) N/O MC KINLEY AVE)	G 4656
BASELINE (2005)	965.205 294.195	COE BM MON IN C B 14M(46FT) E/O C/L WHITE AVE & 16M(52.5FT) N/O N END BRIDGE OVER THOMPSON CREEK 21M(69FT) S/O C/L GATE #5 MKD (TSJ 120 1960) 462M N/O MC KINLEY AVE	G 4657
BASELINE (2005)	1,003.511 305.871	DPW BM TAG IN E CB WHITE AVE 14M(46FT) E/O C/L 3M(9.8FT) N/O BCR ISLE @ GATE #14 TO CO FAIR GROUNDS (644M(0.4MI) S/O ARROW HWY)	G 4659
BASELINE (2005)	1,067.370 325.335	DPW BM TAG E CB 300MM(1FT) S/O BCR @ NE COR WHITE AVE & BONITA AVE 12M(39.4FT) N/O & 7.5M(24.6FT) E/O C/L INT	G 4660
BASELINE (2005)	1,156.038 352.361	DPW BM TAG IN C B 9M(29.5FT) E/O BCR @ NE COR FOOTHILL BLVD & TOWNE CTR DR 24.5M(79FT) E/O & 13M(42.7FT) N/O C/L INT	G 4661
BASELINE (2005)	1,142.427 348.213	DPW BM TAG IN C B 1.5M(4.9FT) E/O BCR @ NE COR FOOTHILL BLVD & FRUIT ST	G 4662

QUAD YEAR	ELEV FOOT/METER	DESCRIPTION	BM NUMBER
BASELINE (2005)	1,178.837 359.311	SPK&W IN N CB BASELINE RD 12M(39FT) N/O C/L & 18M(59FT) E/O C/L PROD FRUIT ST	G 4663
BASELINE (2005)	1,122.431 342.118	DPW BM TAG IN S CB @ BCR SE COR ARROW HWY & VILLANOVA DR 12M(39.4FT) E/O & 10M(32.8FT) S/O C/L INT	G 4664
BASELINE (2005)	1,157.128 352.694	DPW BM TAG IN W CB 300MM(1FT) N/O BCR @ NW COR ARROW HWY & CLAREMONT BLVD 19M(62.3FT) N/O & 13M(42.7FT) W/O C/L INT	G 4665
BASELINE (2005)	1,399.937 426.702	DPW BM TAG IN E CB 8M(26.2FT) N/O BCR @ NE COR BASELINE RD & INDIAN HILL RD & 30M(98FT) N/O & 12M(39.4FT) E/O C/L INT	G 4668
BASELINE (2005)	1,274.395 388.437	DPW BM TAG S CB BASELINE RD 11M(36FT) S/O C/L & 9M(29.5FT) E/O C/L DRWY TO HSE #2884	G 4671
BASELINE (2005)	1,194.470 364.076	DPW BM TAG IN N CB 8.5M(28FT) E/O BCR @ NE COR BASELINE RD & RODEO LN 26M(85.3FT) E/O & 12M(39.4FT) N/O C/L INT	G 4672
BASELINE (2005)	857.705 261.429	DPW BM TAG IN S CB 1M(3.3FT) W/O BCR @ SW COR FIRST ST & PARK AVE 19M(62.3FT) W/O & 6M(20FT) S/O C/L INT (@ F HYD)	G 4966
BASELINE (2005)	859.682 262.032	DPW BM TAG IN E CB NR N END PARKWAY DRAIN 11M(36FT) S/O C/L FIRST ST & 7.5M(24.6FT) E/O C/L MAIN ST	G 4967
BASELINE (2005)	869.208 264.935	DPW BM TAG IN W CB 2.5M(8.2FT) S/O S END RAMP 11M(36FT) S/O C/L FIRST ST & 8.5M(28FT) W/O C/L PALOMARES ST	G 4968
BASELINE (2005)	869.466 265.014	DPW BM TAG IN E CB 1M(3.3FT) S/O S END RAMP 10.5M(34.4FT) S/O C/L FIRST ST & 8.5M(28FT) W/O C/L PALOMARES ST	G 4969
BASELINE (2005)	878.469 267.758	DPW BM TAG IN S CB 1M(3.3FT) E/O BCR @ SE COR FIRST ST & SAN ANTONIO AVE 21M(69FT) W/O & 6M(19.7FT) S/O C/L INT	G 4970
BASELINE (2005)	873.489 266.240	BR DISC IN E CB 1M(3.3FT) S/O BCR @ SE COR WHITE AVE & CHESTER PL 17M(56FT) S/O & 10.5M(34.4FT) E/O C/L INT MKD (YLF 104 1994)	G 4971
BASELINE (2005)	905.245 275.920	L&BR IN N CB 13M(42.7FT) E/O BCR @ NE COR WHITE AVE & PRECIADO ST 36M(118FT) E/O & 7.6M(25FT) N/O C/L INT	G 4972
BASELINE (2005)	1,016.076 309.701	DPW BM TAG IN E CB 1M(3.3FT) N/O BCR @ NE COR ENT TO BLDG #1510 WHITE AVE 13M(42.7FT) E/O C/L & 10M(32.8FT) E/O C/L DRWY (@ F HYD)	G 4973
BASELINE (2005)	1,159.187 353.321	DPW BM TAG IN E CB 1M(3.3FT) N/O BCR @ NE COR FRUIT ST & AMHERST ST 16.5M(54FT) N/O & 12.8M(42FT) E/O C/L INT	G 4974
POMONA (2005)	941.205 286.880	L&BR IN E CB 300MM(1FT) S/O BCR @ SE COR KINGSLEY AVE & INDIAN HILL BL 16M(52.5FT) S/O & 10.5M(34.4FT) E/O C/L INT	G 5113
BASELINE (2005)	1,189.476 362.553	CITY OF UPLAND BM MON IN SW COR C B ON C/L ISLE HUNTINGTON DR 3.5M(11.5FT) N/O C/L & 21M(69FT) E/O C/L CLAREMONT BLVD MKD (BM #17G-86)	G 5114
BASELINE (2005)	1,234.643 376.320	CITY OF UPLAND BM MON IN WK 1M(3.3FT) E/O BCR @ NW COR CLAREMONT BLVD & SIXTH ST 20M(65.6FT) W & 6M(19.7FT) N/O C/L INT MKD (BM #16 G-86)	G 5115

QUAD YEAR	ELEV FOOT/METER	DESCRIPTION	BM NUMBER
BASELINE (2005)	1,236.636 376.928	DPW BM TAG IN N CB 300MM(1FT) E/O BCR @ NE COR CLAREMONT BLVD & SIXTH ST 24M(78.7FT) E/O & 6M(20FT) N/O C/L INT	G 5116
BASELINE (2005)	1,267.959 386.475	DPW BM TAG IN N CB 300MM(1FT) W/O BCR @ NW COR CLAREMONT BLVD & NINTH ST 23M(75.5FT) W/O & 7.5M(24.6FT) N/O C/L INT	G 5117
BASELINE (2005)	1,323.395 403.372	L&N IN S CB 300MM(1FT) E/O BCR @ SE COR CLAREMONT BLVD & FOOTHILL BLVD 23M(75.5FT) E/O & 15M(49.2FT) S/O C/L INT	G 5118
POMONA (2005)	1,488.544 453.710	CAL-TRANS TAG IN S CB BASELINE RD 11.5M(37.7FT) S/O C/L ON C/L PROD CLAREMONT HEIGHTS DR	G 5120
BASELINE (2005)	1,448.822 441.602	L&T IN S CB BASELINE RD 12M(39.4FT) S/O C/L ON C/L PROD BONNIE BRAE AVE	G 5122
BASELINE (2005)	1,368.673 417.173	RCE TAG IN S CB BASELINE RD 12M(39.4FT) S/O C/L & 11.5M(37.7FT) E/O C/L PROD VILLA MARIA RD	G 5123
POMONA (2005)	1,605.563 489.377	DPW BM TAG @ SW COR CONC DRWY TO #3300 PADUA AVE THREE VALLEY WATER 22M(72FT) E/O C/L & 4.5M(14.7FT) N/O C/L MIRAMAR AVE	G 5126
POMONA (2005)	1,644.365 501.204	DPW BM TAG IN E END CONC DRWY TO HSE #3521PADUA AVE 34M(111FT) W/O C/L & 8M(26.2FT) N/O C/L ALAMOSA DR	G 5127
POMONA (2005)	1,717.699 523.556	L&BR IN E CB 1M(3.3FT) N/O ANGLE PT @ NE COR PADUA AVE & AMARILLO DR	G 5128
POMONA (2005)	1,750.696 533.614	RDBM TAG IN W CB 300MM(1FT) S/O BCR @ SW COR PADUA AVE & LITTLE ROCK	G 5129
POMONA (2005)	1,578.928 481.259	L&T IN W CB 300MM(1FT) N/O BCR @ NW COR MILLS AVE & HOLYPOKE PL	G 5131
POMONA (2005)	1,490.666 454.356	DPW BM TAG IN S CB 1M(3.3FT) E/O BCR @ SE COR FORBES AVE & MIRAMIR AVE	G 5132
POMONA (2005)	1,102.548 336.058	DPW BM TAG IN S CB ARROW HWY 14M(46FT) S/O C/L & 9M(29.5FT) E/O C/L PROD DE PAUL RD (CUL-DE-SAC)	G 5133
POMONA (2005)	1,056.537 322.033	L&T IN S CB 300MM(1FT) E/O BCR @ SE COR ARROW HWY & ORANGE GROVE AVE 12M(39.4FT) S/O & 18M(59FT) E/O C/L INT	G 5134
POMONA (2005)	1,038.049 316.398	L&PK NAIL IN N CB 1M(3.3FT) E/O BCR @ NE COR ARROW HWY & MARIPOSA ST 13.5M(44.3FT) N/O & 16M(52.5FT) E/O C/L INT	G 5135
POMONA (2005)	1,031.284 314.336	L&BR IN S CB ARROW HWY (ON ISLE) 12M(39.4FT) S/O C/L & 27M(88.6FT) W/O C/L LA VERNE AVE	G 5136
POMONA (2005)	1,278.344 389.640	L&T IN CB RET 2.5M(8.2FT) E/O BCR @ NW COR TOWNE AVE & RIDGEFIELD DR	G 5137
POMONA (2005)	1,254.026 382.228	L&T IN CB RET 600MM(2FT) E/O BCR @ NW COR TOWNE AVE & HILLSDALE DR	G 5138
POMONA (2005)	1,253.199 381.976	L&T IN CB RET 600MM(2FT) E/O BCR @ SW COR TOWNE AVE & HILLSDALE DR	G 5139

QUAD YEAR	ELEV FOOT/METER	DESCRIPTION	BM NUMBER
POMONA (2005)	1,227.317 374.087	L&PK NAIL IN W CB 300MM(1FT) S/O BCR @ SW COR TOWNE AVE & BRAIRCROFT RD	G 5140
POMONA (2005)	1,196.144 364.586	L&BR IN W CB 150MM(0.5FT) S/O BCR @ SW COR TOWNE AVE & FOOTHILL BLVD	G 5141
POMONA (2005)	1,246.730 380.004	L&BR IN E CB 300MM(1FT) N/O BCR @ NE COR FOOTHILL BLVD & COLBY CIRCLE DR	G 5142
POMONA (2005)	1,182.170 360.327	L&PK NAIL IN S CB FOOTHILL BLVD 11M(36FT) S/O C/L & 5.5M(18FT) W/O C/L PROD LYNOAK DR	G 5143
POMONA (2005)	1,175.111 358.175	L&PK NAIL IN S CB FOOTHILL BLVD 11M(36FT) S/O C/L & 4M(13FT) W/O C/L PROD SUMMER AVE	G 5144
POMONA (2005)	1,157.411 352.780	DPW BM TAG S CB 300MM(1FT) S/O BCR @ SW COR FOOTHILL BLVD & FALCON ST	G 5145
POMONA (2005)	1,057.341 322.279	L&PK IN N CB ARROW HWY 13M(42.7FT) N/O C/L & NR C/L PROD ORANGE GROVE AVE	G 5281
POMONA (2005)	1,071.458 326.581	LACO DPW BM TAG IN S CB 300MM(1FT) E/O BCR @ SE COR ARROW HWY & TOWNE AVE 13M(42.7FT) S/O & 21M(69FT) E/O C/L IT	G 5282
BASELINE (2005)	1,109.241 338.098	LACO BM TAG IN W CB 5M(16.4FT) S/O BCR @ SW COR ARROW HWY & INDIAN HILL BLVD	G 5283
BASELINE (2005)	1,142.753 348.312	L&T IN S CB 2M(6.5FT) W/O BCR @ SE COR ARROW HWY & OAKDALE DR 10M(32.8FT) S/O & 13.5M(44.3FT) E/O C/L INT	G 5284
BASELINE (2005)	1,324.637 403.751	LACO BM TAG IN NE CB RET 2.5M(8.2FT) S/O BCR 22M(72FT) N/O C/L FOOTHILL BLVD & CLAREMONT BLVD	G 5285
POMONA (2005)	1,090.708 332.449	RAMSET IN S CB 100MM(4IN) E/O BCR @ SE COR TOWNE CENTER DR & TOWNE AVE	G 5286
POMONA (2005)	1,118.996 341.071	LACO BM TAG IN W CB 2M(6.5FT) N/O BCR @ NW COR TOWNE AVE & BONITA AVE (S END C. B.)	G 5287
BASELINE (2005)	1,301.059 396.564	CAL-TRANS TAG IN N CB 100MM(0.3FT) W/O BCR @ NW COR TOWNE AVE BASELINE RD & 17M(56FT) W/O & 10.5M(34.4FT) N/O C/L INT	G 5288
POMONA (2005)	1,161.937 354.159	LACO BM TAG S CB @ SW COR OF BRIDGE OVER THOMPSON CREEK 13M(43FT) S/O C/L FOOTHILL BLVD & 11M(36FT) E/O C/L PROD WILLIAMS AVE	G 5289
POMONA (2005)	1,167.150 355.748	L&PK NAIL IN E CB 300MM(1FT) S/O BCR @ SE COR FOOTHILL BLVD & GAREY AVE	G 5290
POMONA (2005)	1,290.728 393.415	L&T IN S CB 6M(19.7FT) W/O E END STEPS @ ENT TO HARVEY MUDD COLL 14M(46FT) S/O C/L FOOTHILL BLVD & 325M(0.2MI) E/O C/L COLLEGE AVE	G 5291
BASELINE (2005)	1,440.685 439.122	LACO BM TAG IN E CB MILLS AVE 10.5M(34FT) E/O C/L & 5M(16.4FT) N/O C/L RADCLIFF DR (@HSE #1924)	G 5292
BASELINE (2005)	1,224.368 373.188	LACO BM TAG IN W CB 300MM(1FT) N/O BCR @ NW COR BASELINE RD & SAINT MARK ST 21M(69FT) N/O & 4.5M(14.8FT) W/O C/L INT	G 5293

QUAD YEAR	ELEV FOOT/METER	DESCRIPTION	BM NUMBER
BASELINE (2005)	1,226.871 373.951	LACO BM TAG IN S CB BASELINE RD 13M(42.7FT) S/O C/L & 4M(13FT) E/O C/L PROD SAINT MARK ST	G 5294
BASELINE (2005)	1,316.810 401.365	LACO BM TAG IN S CB BASELINE RD 11M(36FT) S/O C/L & 325M(0.2MI) W/O NEW LIVE OAK CYN RD @ PP #4461261E	G 5295
BASELINE (2005)	1,348.754 411.101	LACO BM TAG IN S CB 300MM(1FT) W/O BCR @ SW COR BASELINE RD & NEW LIVE OAK CYN RD 16M(52.5FT) W/O & 11M(36FT) S/O C/L INT	G 5296
BASELINE (2005)	1,348.952 411.162	LACO BM TAG IN S CB 300MM(1FT) E/O BCR @ SE COR BASELINE RD & NEW LIVE OAK CYN RD 16M(52.5FT) E/O & 11M(36FT) S/O C/L INT	G 5297
BASELINE (2005)	1,304.197 397.520	LACO BM TAG IN S CB BASELINE RD 11M(36FT) S/O C/L & 1M(3.3FT) E/O C/L PROD WEBB CYN RD	G 5298
BASELINE (2005)	1,328.753 405.005	LACO BM TAG IN S CB BASELINE RD 12.5M(41FT) S/O C/L & 15M(49FT) E/O C/L W DRWY TO EDISON STATION (OPP HSE #923)	G 5299
BASELINE (2005)	1,349.495 411.327	LACO BM TAG IN N CB 300MM(1FT) W/O BCR @ NW COR BASELINE RD & MOUNTAIN AVE 13.5M(44.3FT) W/O & 12.5M(41FT) N/O C/L INT	G 5300
BASELINE (2005)	1,349.494 411.327	CAL-TRANS DISK IN S CB 1.5M(5FT) W/O BCR @ SE COR BASELINE RD & MOUNTAIN AVE 21M(69FT) S/O & 8.5M(28FT) E/O C/L INT	G 5301
POMONA (2005)	1,518.439 462.822	LACO BM TAG IN S CB 300MM(1FT) W/O BCR @ SW COR BASELINE RD & MONTE VISTA AVE	G 5302
POMONA (2005)	1,518.341 462.792	LACO BM TAG IN N CB 300MM(1FT) W/O BCR @ NW COR BASELINE RD & PADUA AVE	G 5303
POMONA (2005)	1,785.258 544.148	L&BRAD IN SW COR CONC V-GUTTER @ SE COR PADUA AVE & FULLER DR 6.5M(21.3FT) E/O & 5.3M(17.4FT) S/O C/L INT	G 5304
POMONA (2005)	1,786.094 544.403	L&BRAD IN NW COR CONC V-GUTTER @ NE COR PADUA AVE & FULLER DR 6.5M(21.3FT) E/O & 5.3M(17.4FT) N/O C/L INT	G 5305
POMONA (2005)	1,740.767 530.587	LACO BM TAG IN SE COR CONC DRWY APRON TO HSE #4111 MT BALDY RD 5.2M(17FT) W/O C/L & 402M(0.25MI) N/O VIA PADOVA	G 5306
BASELINE (2005)	877.277 267.395	L&T W CB 300MM(1FT) S/O BCR @ SW COR 1ST ST & SAN ANTONIO AV 10M(32.8FT) W/O & 15M(49.2FT) S/O C/L INT	G 5442
BASELINE (2005)	882.338 268.937	L & DPW BM TAG S CB 1ST ST 67M(219.8FT) W/O C/L SAN ANTONIO AV & 7M(23FT) S/O C/L 1ST ST	G 5443
BASELINE (2005)	883.551 269.307	L & DPW BM TAG N CB 1ST ST 67M(219.8FT) W/O C/L SAN ANTONIO AV & 7M(23FT) N/O C/L 1ST ST	G 5444
BASELINE (2005)	1,405.292 428.334	L&RCE7344 TAG IN E CB 1.5M(5FT) S/O BCR @ SE COR BLACK HILLS DR & MILLS AV 9.1M(30FT) E/O & 15.2M(50FT) S/O C/L INT	G 5445
POMONA (2005)	1,647.408 502.131	L & LACO BM TAG ON ROCK @ NE COR MILLS AV & MT BALDY RD 13.7M(45FT) N/O & 8.5M(28FT) E/O C/L INT	G 5453
POMONA (2005)	1,803.089 549.583	L & LACO BM TAG IN CONC @ SW COR MT BALDY RD & PADUA AV 12.2M(40FT) W/O & 11M(36FT) S/O C/L INT	G 5454

QUAD YEAR	ELEV FOOT/METER	DESCRIPTION	BM NUMBER
POMONA (2005)	1,558.313 474.975	L & LACO BM TAG IN W CB 12.8M(42FT) W/O C/L PADUA AV & 7.6M(25FT) S/O KEMPER AV	G 5455